

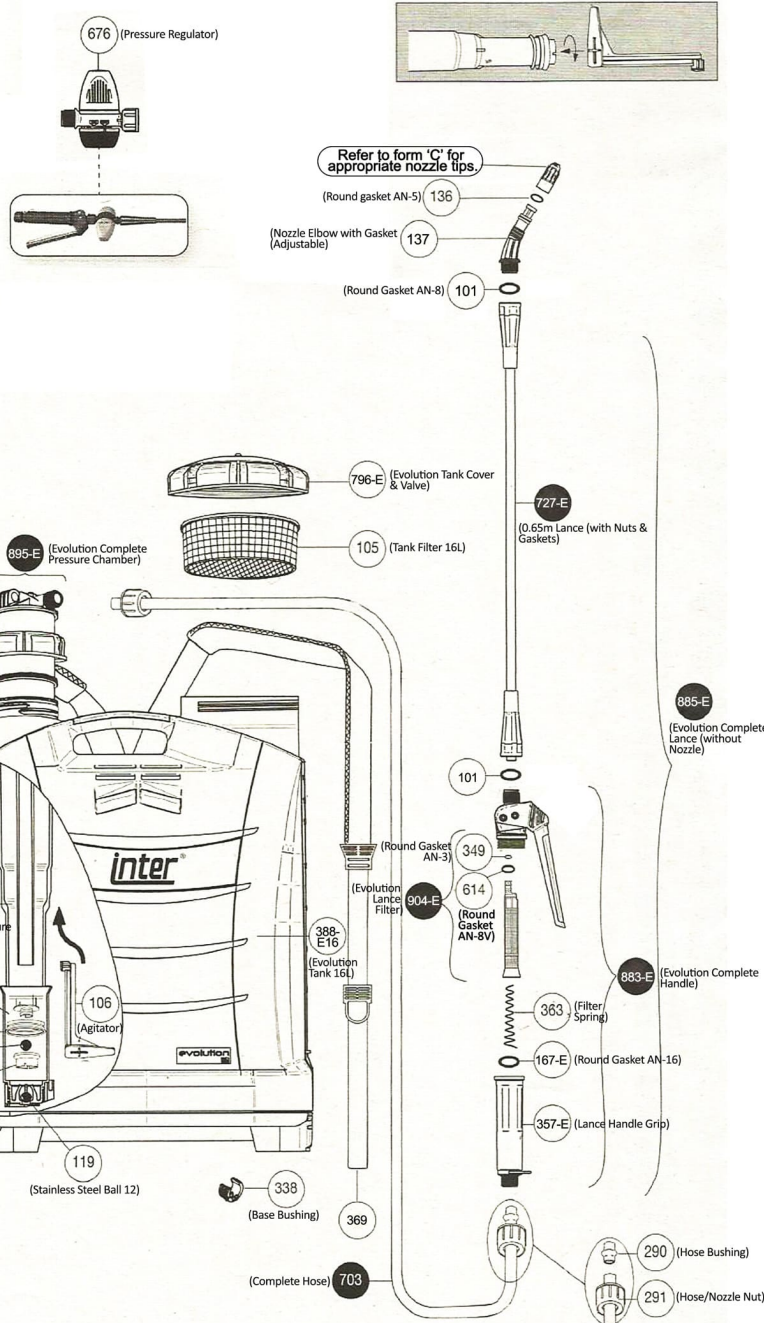

Inter Evolution Parts



*133A - Rubber Seal
 *133B - Opaque Synthetic Seal
 *133C - Viton Seal

Parts	Part NO.	Name of Part	Per Pack	No. Of Pack(s)
	167	Round Gasket AN-14	5 units	
	167-E	Round Gasket AN-16	5 units	
	349	Round Gasket AN-3	5 units	
	356-CHB	Complete Handle Body	1 unit	
	357	Lance Handle Grip	1 unit	
	363	Filter Spring	3 units	
	608	Round Gasket AN-6	5 units	
	614-E	Round Gasket AN-8V (Viton)	5 units	
	904	Lance Filter (With Gasket)	1 unit	
	904-E	Evolution Lance Filter (With Gasket)	1 unit	
	883	Complete Handle	1 set	
	883-E	Evolution Complete Handle	1 set	
	119	Stainless Steel Ball 12	3 units	
	133A	Rubber Seal	5 units	
	133B	Opaque Synthetic Seal	5 units	
	133C	Viton Seal	5 units	
	136	Round Gasket AN-5	5 units	
	365	Chamber Valve	1 unit	
	366	Chamber Lubricant Pad	5 units	
	368B	Pressure Chamber (Black)	1 unit	
	368-E	Evolution Pressure Chamber (Black)	1 unit	
	368E-W	Evolution Pressure Chamber (White)	1 unit	
	895	**Complete Pressure Chamber (Older Model)	1 set	
	895-E	Evolution Complete Pressure Chamber	1 set	
	895-E(W)	Evolution Complete Pressure Chamber (White)	1 set	
	105A	Tank Filter 12 L	1 unit	
	105	Tank Filter 16 L	1 unit	
	388-E16	Evolution Tank 16 L (with cylinder – Part NO. 710) + Complete Lever	1 unit	
	388-E12	Evolution Tank 12 L (with cylinder – Part NO. 710) + Complete Lever	1 unit	
	796A	Tank Cover & Valve 12L	1 unit	
	796	Tank Cover & Valve 16L	1 unit	
	796-E	Evolution Tank Cover & Valve	1 unit	
	101	Round Gasket AN-8	5 units	
	127	Cone Nut	5 units	
	138	DIA 10 Cone	5 units	
	727-A	0.5m Lance (with nuts & gaskets)	1 unit	
	727	0.7m Lance (with nuts & gaskets)	1 unit	
	727-LAA	0.7m Lance (with nuts & gaskets + aluminium adaptor)	1 unit	
	727-E	0.65m Lance (with nuts & gaskets)	1 unit	
	318	Belt Wedge	5 units	
	369	Strap (left side)	1 set	
	369+318	Strap with wedge (left side)	1 set	
	819	Strap with attached Hook (right side)	1 unit	
	369+819	Straps (for both sides)	1 set	
	106	Agitator	1 unit	
	115	8x40 Screw and Washer	1set	
	126	Lever Grip	1 unit	
	137	Nozzle Elbow with gasket (Adjustable)	2 units	
	290	Hose Bushing	5 units	
	291	Hose/Nozzle Nut	5 units	
	338	Base Bushing	5 units	
	374	Guide Lid	1 unit	
	374-E	Evolution Guide Lid	1 unit	
	374-U	Guide Lid	1 unit	
	495	Cotter Pin	10 units	
	703	Complete Hose	1 unit	
	710A	Cylinder with Ball (screw type)	1 unit	
	710	Cylinder with Ball	1 unit	
	885	Complete Lance (without nozzle)	1 set	
	885-E	Evolution Complete Lance (without nozzle)	1 set	
	896-G	Complete Lever (with Grip + Base Bushing)	1 set	
	896-E	Complete Lever (with Grip + Base Bushing)	1 set	
	953	Lance Hook	1 unit	
	& Others			

**Complete pressure chamber with chamber valve, stainless steel ball + viton seal

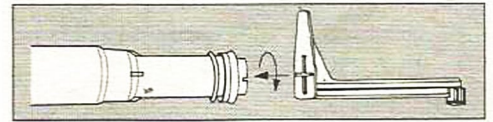
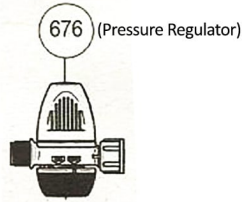

Refer to form 'C' for appropriate nozzle tips.

(Round gasket AN-5) 136

(Nozzle Elbow with Gasket (Adjustable)) 137

(Round Gasket AN-8) 101

727-E

(0.65m Lance (with Nuts & Gaskets))

885-E

(Evolution Complete Lance (without Nozzle))

101

(Round Gasket AN-3) 349

(Evolution Lance Filter) 904-E

614

(Round Gasket AN-8V)

883-E (Evolution Complete Handle)

363 (Filter Spring)

167-E (Round Gasket AN-16)

357-E (Lance Handle Grip)



796-E (Evolution Tank Cover & Valve)

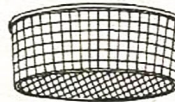

105 (Tank Filter 16L)

895-E (Evolution Complete Pressure Chamber)

(Lance Hook) 953

(Evolution Guide Lid) 374-E

(Chamber Lubricant Pad) 366

126

(Lever Grip)

896-G

(Complete Lever (with Grip & Base Bushing))

(Strap (Left Side)) 369

(Evolution Pressure Chamber) 368-E

(Cylinder with Ball) 710

(*Seal) 133*

119

(Chamber Valve) 365

106

(Agitator)

119

(Stainless Steel Ball 12)

(Evolution Tank 16L) 388-E16

338

(Base Bushing)

369

(Complete Hose) 703

290 (Hose Bushing)

291 (Hose/Nozzle Nut)

*133A - Rubber Seal
 *133B - Opaque Synthetic Seal
 *133C - Viton Seal

inter

Mod. INTER 12-16 GREEN
Ref. / Cod. 8.39.69
Ref. / Cod. 8.39.67

Mycrop

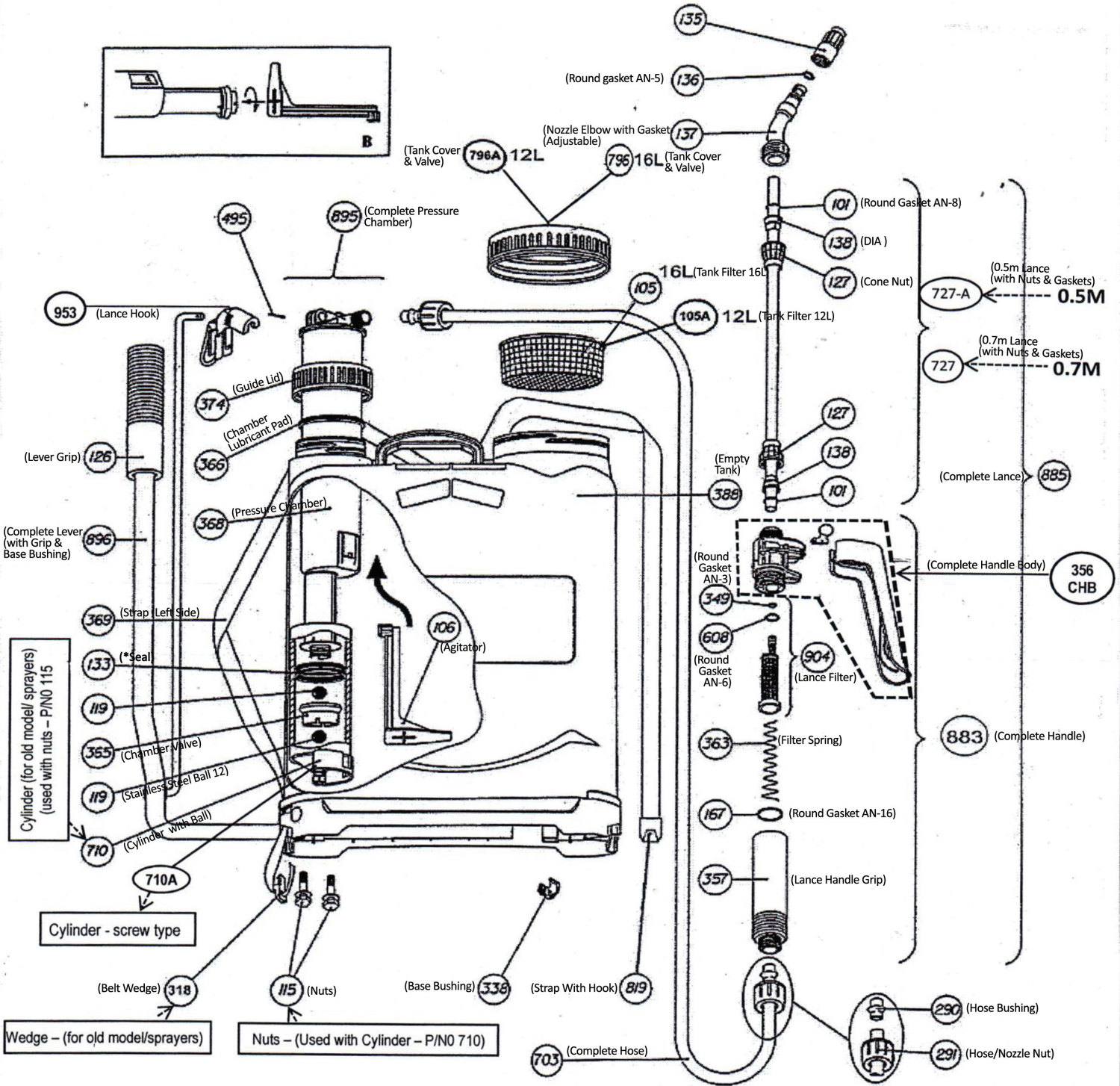

Part NO: 710A



Cylinder (Screw Type)

Part NO: 710



Cylinder (For old model/sprayers)

Part NO: 356-CHB



Complete Handle Body

Part NO: 133

133A – Rubber Seal
133B – Opaque Synthetic Seal
133C – Viton seal