

Matabi evolution

Name of parts and Diagram

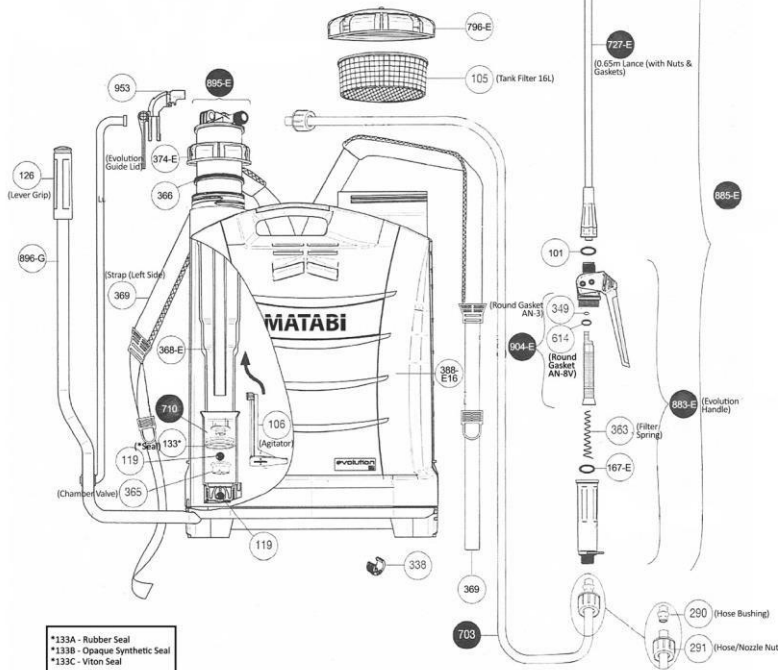

Parts	Part NO.	Name of Part	Per Pack
	167	Round Gasket AN-14	5 units
	167-E	Round Gasket AN-16	5 units
	349	Round Gasket AN-3V (Viton)	5 units
	608	Round Gasket AN-6V (Viton)	5 units
	614-E	Round Gasket AN-8V (Viton)	5 units
	904-E	Evolution Lance Filter (With Gasket)	1 unit
	883-E	Evolution Complete Handle	1 set
	119	Stainless Steel Ball 12	3 units
	133A	Rubber Seal	5 units
	133B	Opaque Synthetic Seal	5 units
	133C	Viton Seal	5 units
	365	Chamber Valve	1 unit
	366	Chamber Lubricant Pad	5 units
	368-E-B	Evolution Pressure Chamber (Black)	1 unit
	368-E-W	Evolution Pressure Chamber (White)	1 unit
	895-E-B	Evolution Complete Pressure Chamber (Black) with Viton Seal	1 set
	895-E-W	Evolution Complete Pressure Chamber (White) with Viton Seal	1 set
	105A	Tank Filter 12 L	1 unit
	105	Tank Filter 16 L	1 unit
	388-E12	Matabi Evolution Tank 12 L (with cylinder - Part NO. 710) + Complete Lever	1 unit
	388-E16	Matabi Evolution Tank 16 L (with cylinder - Part NO. 710) + Complete Lever	1 unit
	796-E12	Evolution Tank Cover 12L	1 unit
	796-E16	Evolution Tank Cover 16L	1 unit
	101	Round Gasket AN-8	5 units
	101-V	Round Gasket AN-8V	5 units
	127	Cone Nut	5 units
	138	DIA 10 Cone	5 units
	727-E	0.63M Lance (with nuts & gaskets)	1 unit
	369(2)	Straps (2units without hooks)	2 units
	369+819H	Strap Complete Set (2units - one unit with hook)	1 set
	106	Agitator	1 unit
	126-E	Evolution Lever Grip	1 unit
	290	Hose Bushing	5 units
	291	Hose/Nozzle Nut/ Nozzle Holder	5 units
	338	Base Bushing	5 units
	374-E (16L)	Evolution Guide Lid - 16L	1 unit
	374-E (12L)	Evolution Guide Lid - 12L	1 unit
	703	Complete Hose	1 unit
	710A	Cylinder with Ball	1 unit
	885-E	Evolution Complete Lance (without nozzle)	1 set
	896-E	Evolution Complete Lever (with Grip + Base Bushing)	1 set
	953	Lance Hook	1 unit
	363	Filter spring	3 units
	LTC - 6M	Hose - 6M	1 unit
& Others			



*133A - Rubber Seal
 *133B - Opaque Synthetic Seal
 *133C - Viton Seal

[Click link for Nozzle Chart](#)